

## CAST IRON GATE VALVES (NON-RISING STEM)– CLASS 250#

Size range: 2" to 12"

STANDARDS:	
Design	MSS SP-70
Test	MSS SP-70
Face to Face Dimensions	ANSI B16.10
End Flange Dimensions	ANSI B16.1

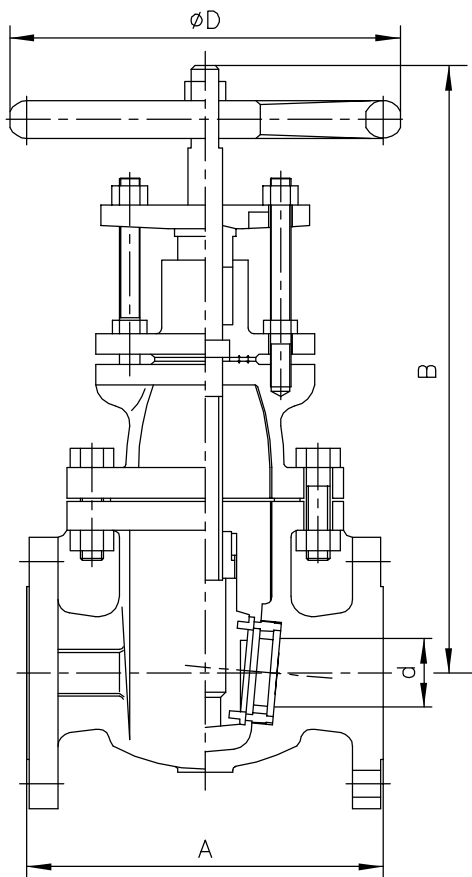

Class 250# Fig No.511250

**DIMENSIONS AND WEIGHTS**

Size inch	d	A (RF)	B	D	Weight (Kg)
2"	51	216	333	200	23
2½"	64	241	379	200	31
3"	76	283	424	250	42
4"	102	305	466	300	69
5"	127	381	527	300	84
6"	152	403	605	350	116
8"	203	419	727	400	194
10"	254	457	812	450	298
12"	305	502	876	505	408

Other Sizes: On request

RF: Flanged

**AVAILABLE OPTIONS:**

STRUCTURE	End, Connection: Flange Raised Face...
	Seat Rings: Threaded (Renewable)
	Operation: Handwheel, Gear, Electric, Pneumatic, Hydraulic...
MATERIALS	Body: Gray Cast Iron, Ductile Iron...
	Trims: Cast Bronze, Brass, Stainless Steel...