

CAST IRON Y-TYPE STRAINER-PN10, CLASS 125

Size range: 2" to 12"

STANDARDS:	
Design	
Test	API 598
Face to Face Dimensions	
End Flange Dimensions	BS 4504

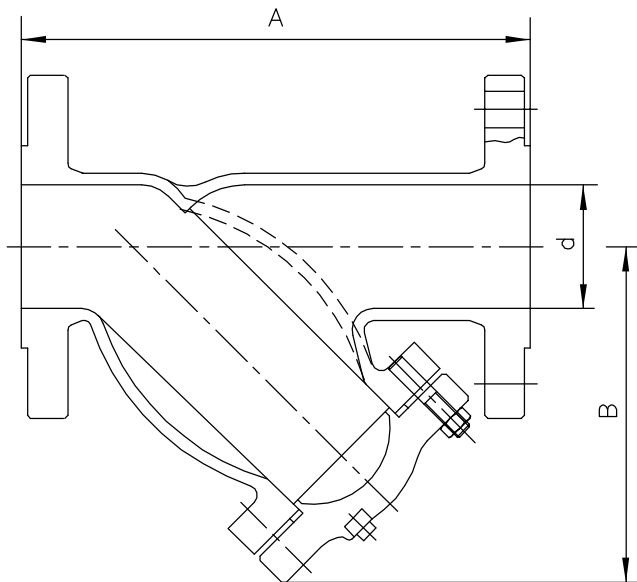

PN10 Fig No.51010
DIMENSIONS AND WEIGHTS

Size inch	d	A (RF)	B	Weight (Kg)
2"	51	220	182	12.5
2 1/2"	64	270	188	15.8
3"	76	290	195	19.5
4"	102	350	246	32
5"	127	390	302	50.5
6"	152	440	320.7	64
8"	203	540	397.5	102
10"	254	660.4	483	182
12"	305	720	560	276

CLASS 125 Fig No.510125
DIMENSIONS AND WEIGHTS

Size inch	d	A (RF)	B	Weight (Kg)
2"	51	225.4	144	12.5
2 1/2"	64	273	176	16.5
3"	76	292.1	195	19.6
4"	102	352.4	246	33
5"	127	390.5	300	51
6"	152	469.9	320.7	67
8"	203	542.9	397.5	103
10"	254	660.4	483	184
12"	305	762	560	286

Other Sizes:On request RF:Flanged

AVAILABLE OPTIONS:

STRUCTURE	End,Connection: Flange Raised Face...
MATERIALS	Body: Gray Cast Iron, Ductile Iron...
	Trims: Stainless Steel, Brass, Bronze...