

GATE VALVES—CLASS 600#

Size range: 2" to 30"

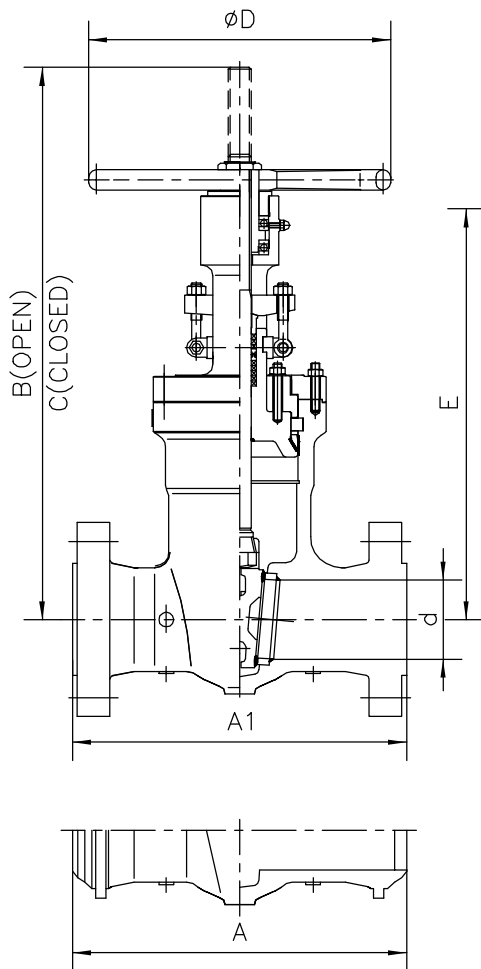

STANDARDS:	
Design	ANSI B16.34 & API 600
Test	API 598
Face to Face Dimensions	ANSI B16.10
End Flange Dimensions	ANSI B16.5
Butt-Weld Ends	ANSI B16.25

Class 600# FIG NO. 5600PS
DIMENSIONS AND WEIGHTS

Size inch	d	A1 (RF)	A (BW)	B (OPEN)	C (CLOSE)	D	E	Weight (Kg)(BW)
2"	51	292	178	407	345	200		17
3"	76	356	254	498	415	250		27
4"	102	432	305	580	470	300		42
6"	152	559	457	790	635	500		100
8"	200	660	584	993	800	660		190
10"	248	787	711	1182	940		985	300
12"	298	838	813	1465	1175		1215	520
14"	327	889	889	1625	1307		1352	690
16"	375	991	991	1820	1458		1502	915
18"	419	1092	1092	1966	1566		1661	1200
20"	464	1194	1194	2240	1800		1885	1630
24"	559	1397	1397	2530	2000		2075	2470
30"	695	1651	1651	3165	2500		2575	5250

Other Sizes: On request

BW: Butt Weld

Sizes 10" and larger the use of gear actuator is recommended

AVAILABLE OPTIONS:

STRUCTURE	End, Connection:	Flange Raised Face, Butt Weld, RTJ...
	Seat Rings:	Threaded (Renewable), Welded
	Operation:	Handwheel, Gear, Electric, Pneumatic, Hydraulic...
MATERIALS	Body:	WCB, WC1, WC6, WC9, LCB, LCC, LC3, C5, C12, CF8, CF8M, CF3, CF3M, CF8C...
	Trims:	13%Cr, 304, 304L, 316, 316L, 321, 347, F-51, Monel...